

Fradiflex metal water stop

Installation instructions – wall/slab connection



- Roll out the 25 m long roll of Fradiflex or set in position 2.1 m long straight sections of Fradiflex. Note, the coated surface should always face towards the water retaining face.
- For angled and curved construction joints simply bend Fradiflex to the required shape.
- Before fixing Fradiflex in position remove the lower section of protective film tape.
- Fradiflex should be positioned centrally between the vertical reinforcement bars.
- Fradiflex is held in position to the upper reinforcement layer with mounting clips and tying wire. Place mounting clips at intervals of approximately 300 to 400 mm. The same fixing method is employed for both straight and rolled sections.
- During the 1st concrete pour, the recommended depth of immersion of Fradiflex is from at least 30 mm up to half the width of the metal water stop. The performance of Fradiflex is not affected if it is not placed straight in the construction joint.



- Joints are simply overlapped over a length of 100 mm (remove protective film tape prior to fixing), the ends are pressed against each other and then secured with a Fradiflex mounting clip.



- Only remove the upper protective film tape prior to installation of the reinforcement and / or before closing the formwork.

Note:

Protect Fradiflex metal water stop against direct sunlight during storage.



Element wall / slab

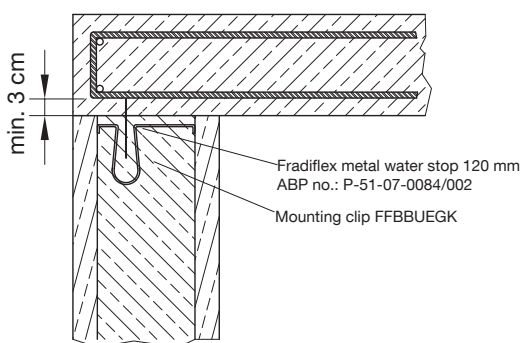

Wall / slab

